

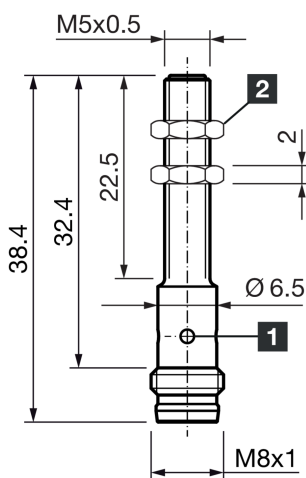

210482
DCC 05 V 1.5 PSK-TSL
Inductive proximity sensor

- Stainless steel housing
- Metal connector M8
- Integrated amplifier
- Short-circuit protection
- Starting pulse suppression
- LED



1) LED 4 x 90° (yellow)

2) Width over flats 7 mm

BK: black

BN: brown

BU: blue

Function



Technical data (typ.)

+20°C, 24 V DC

Service voltage 10 ... 30 V DC

No-load current (max.) 10 mA

Insulation voltage endurance 500 V

Installation type Flush

Thread M5 x 0,5

Housing material Stainless steel (V2A 1.4305 / AISI 303)

Material PBT (Sensor probe)

Protection class III, operation on protective low voltage

Operating principle inductive

Evaluation digital

Design Thread

Characteristics increased operating distance

Product series Miniature design

Switching output pnp, 100 mA, NO

Voltage drop (max.) 1,5 V

Switching distance (SN) 1,5 mm

Standardized measuring plate 5 x 5 x 1 mm

Switching hysteresis (max.) 1 %

LED Anzeige Yes

Switching frequency 5.000 Hz

**210482****DCC 05 V 1.5 PSK-TSL****Inductive proximity sensor****Technical data (typ.)****+20°C, 24 V DC**

Ambient temperature during operation

-25 ... +70 °C

Protection type

IP 67

Connection

Connector, M8, 3-pin

Connection cable

TK ...

More information / accessories<https://www.di-soric.com/210482>